

AQUILA 70



AQUILA

Technical specification

Length overall – 21.26 m / 69' 9"

Beam overall – 8.2 m / 26' 11"

Max Draft – 1.45 m / 4' 9"

Air Draft – 6.65 m / 21' 6"

Light Ship Displacement – 50 t / 110,000 lbs

Design Category – A

Fuel Capacity – 5,480L / 1,447 GAL

Fresh water – 1,560L / 412 GAL

Black water – 740L / 196 GAL

Generator standard – 1 x Kohler 21kW

Generator option – 2 x Kohler 21kW PGEN

Propulsion Standard – 2 x Volvo Penta D11-800 hp

Max Speed/Range – 22kts (25mph) / 357 Nm

Cruising Speed/Range – 19kts (22mph) / 383 Nm

Hull Speed/Range – 9kts (10.3mph) / 1130 Nm

Propulsion option 1 – 2 x Volvo Penta D13-1000 hp

Max Speed/Range – 24.5kts (28mph) / 319 Nm

Cruising Speed/Range – 22kts (25mph) / 352 Nm

Hull Speed/Range – 9kts (10.3mph) / 1117 Nm

All speeds are PRELIMINARY



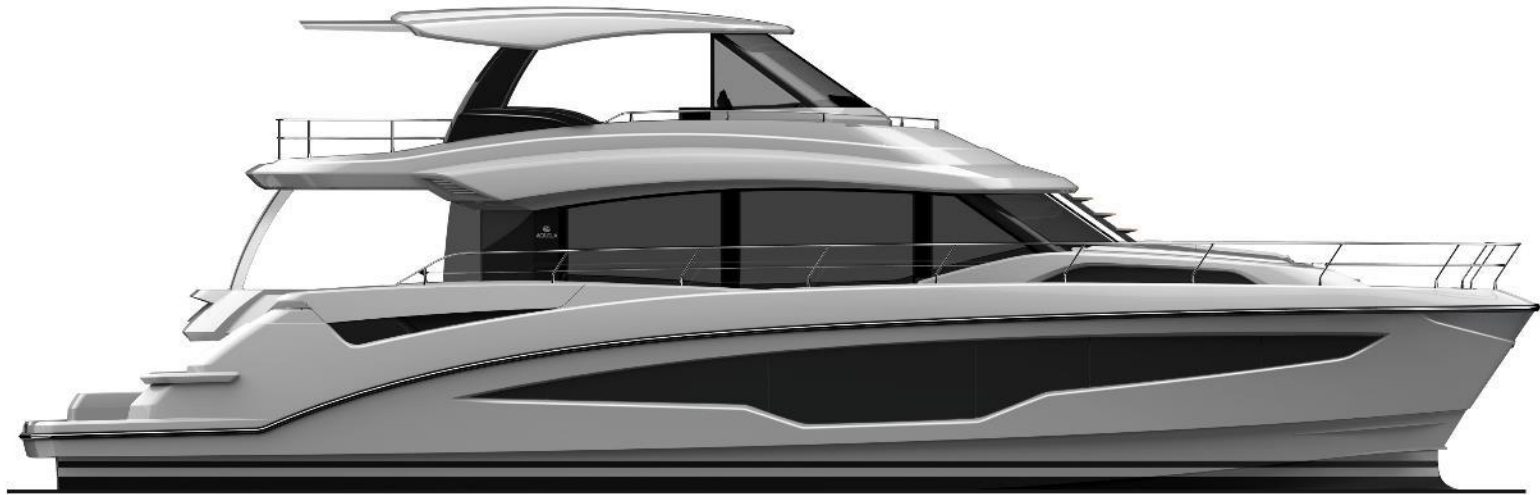

SALON



NATUZZI ITALIA

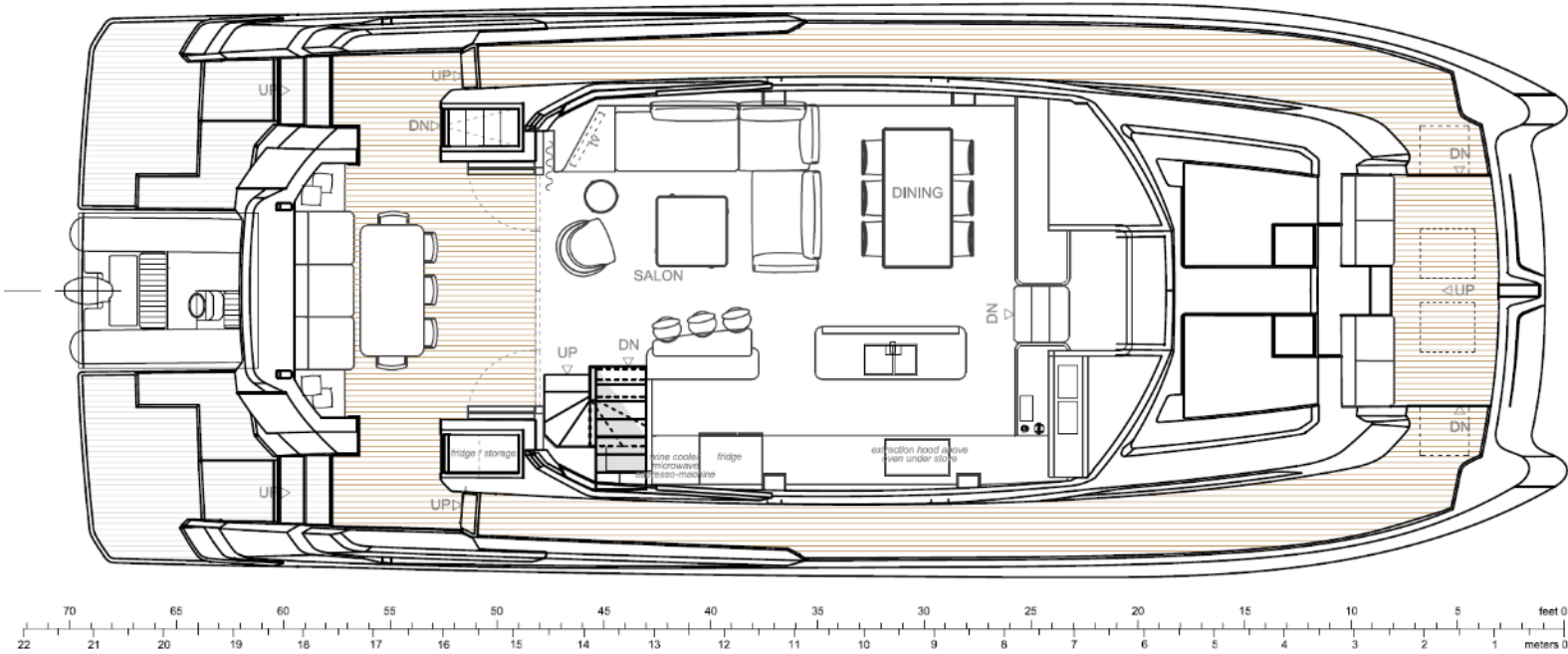

SALON furniture

Manzoni & Tapinassi *designer*

The originality and expressiveness of architect Maurizio Manzoni and the considerable experience of professor Roberto Tapinassi came together in 2001 to form a professional partnership among the most remarkable of Italy. From the start, the two designers shared a common vision of contemporary living, developing innovative solutions in line with an Italian tradition devoted to cutting-edge research.



NATUZZI ITALIA



SALON – galley down version

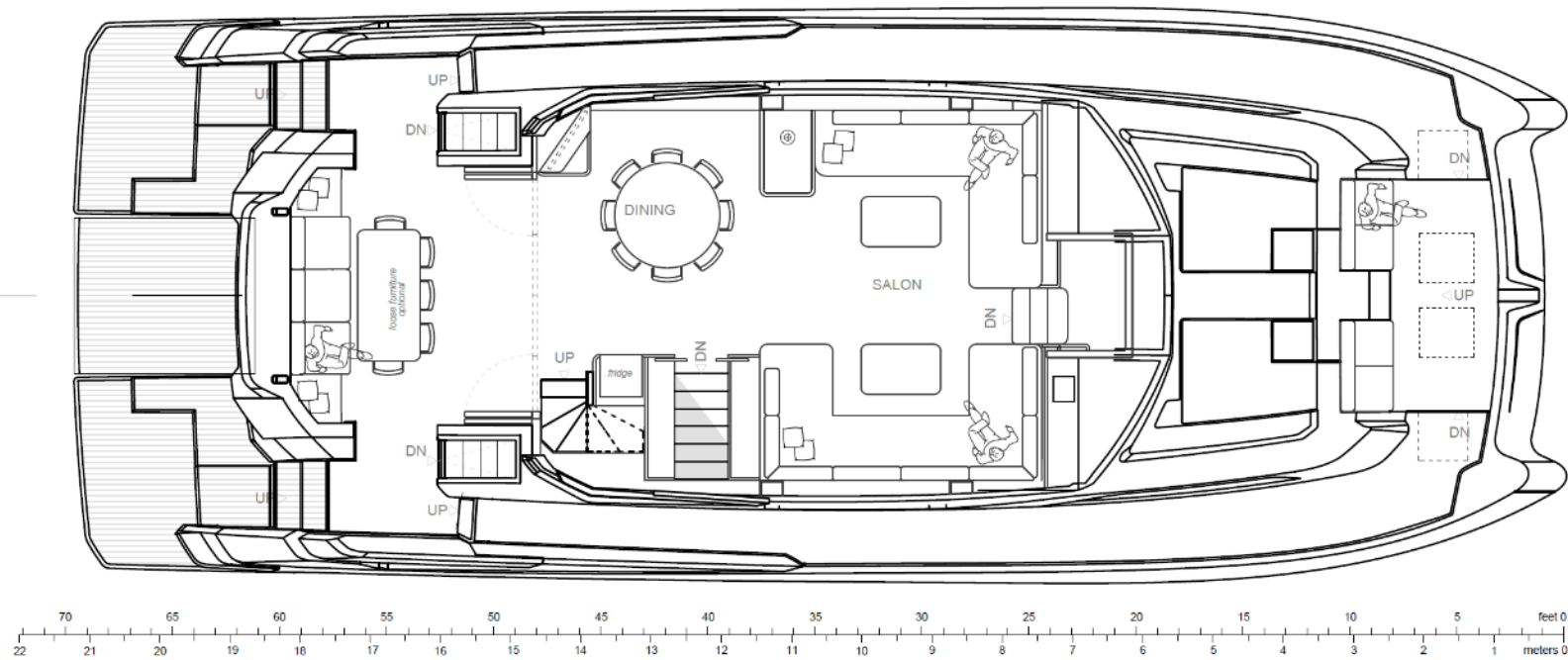

4 CABIN – lower deck layout

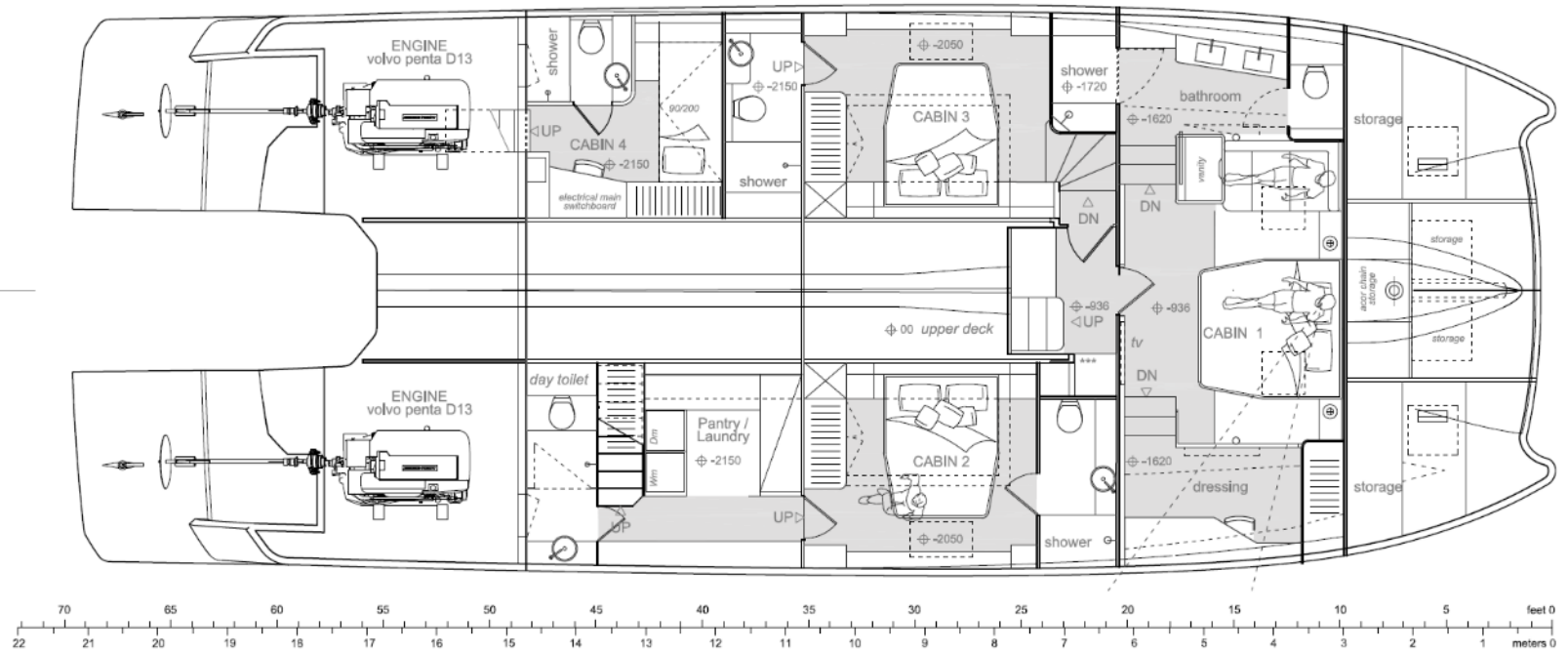

5 CABIN – lower deck layout

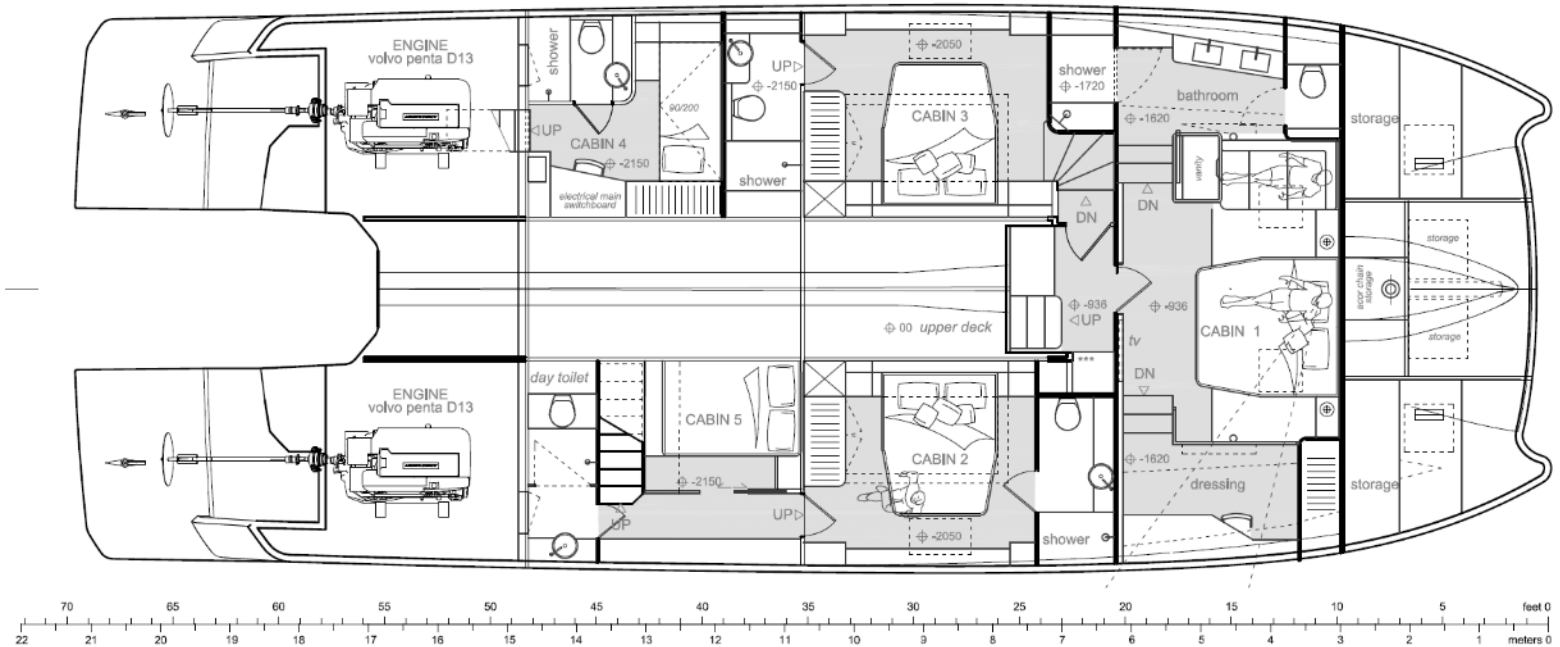

5 CABIN – galley down layout

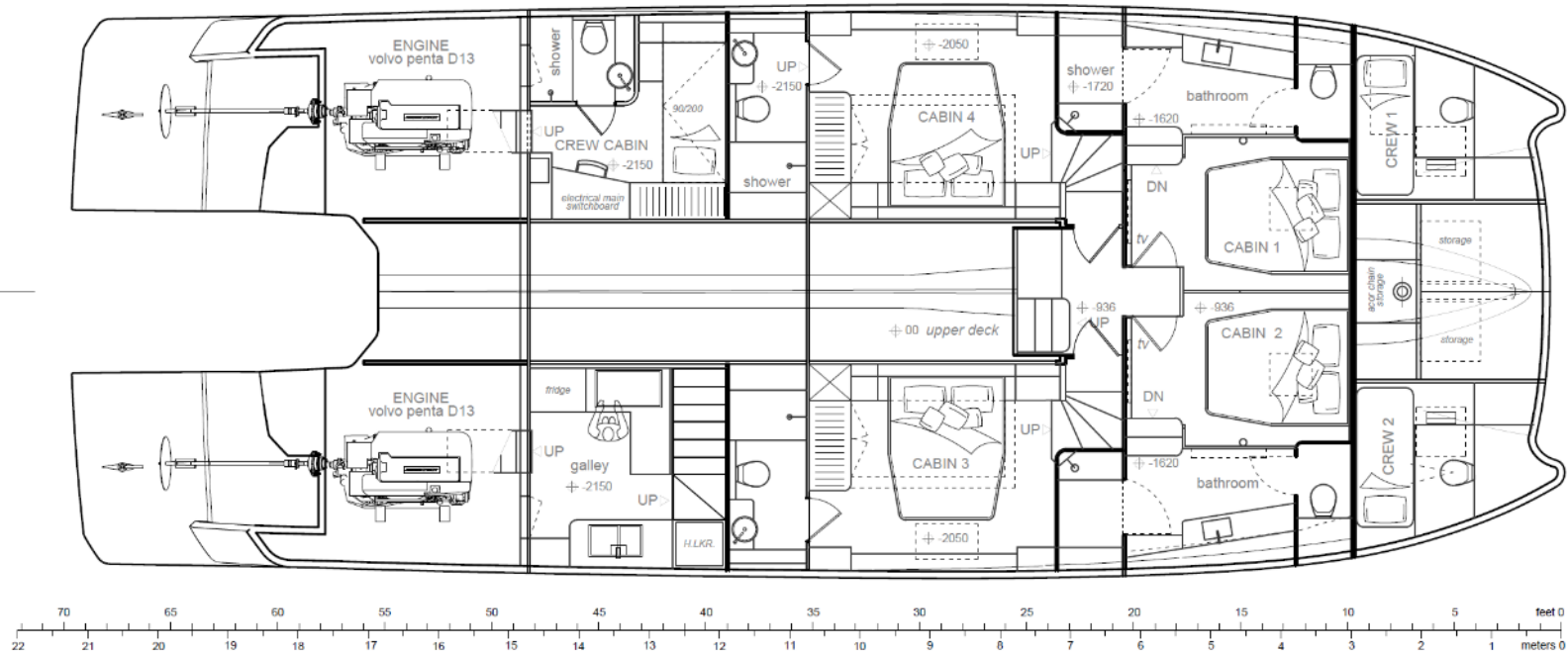

Layout is showing optional 2 cabins in way of Master cabin

FLYBRIDGE – open version

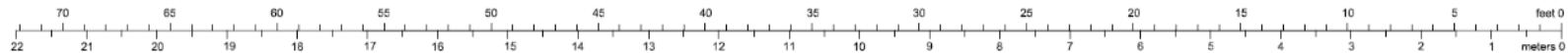
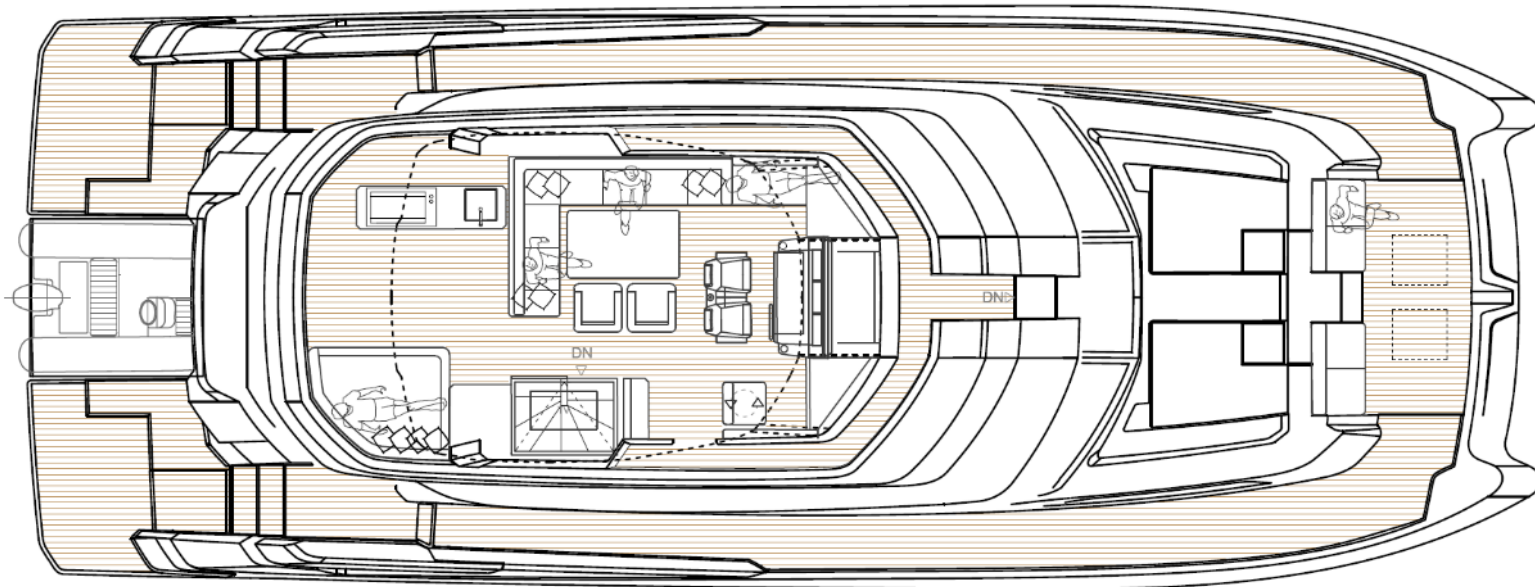
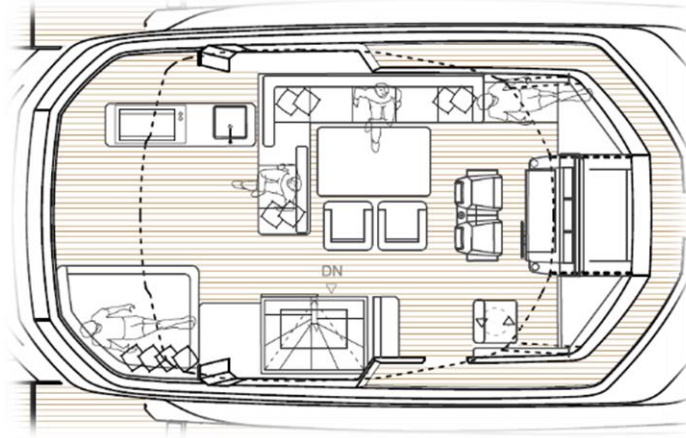

FLYBRIDGE – Skylounge version

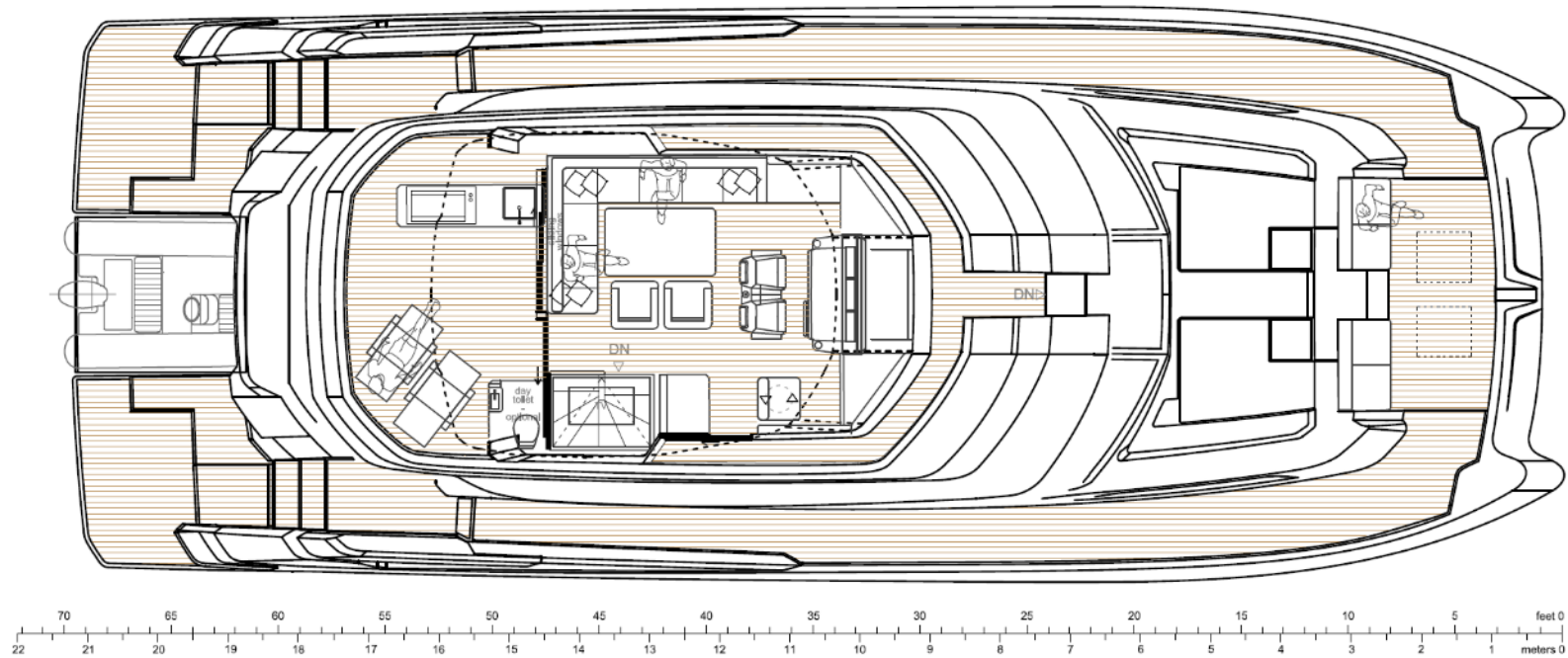

SALON

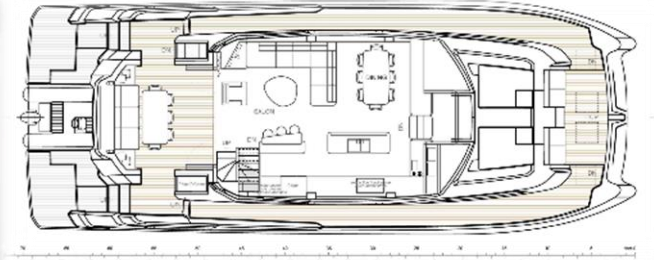

MASTER CABIN

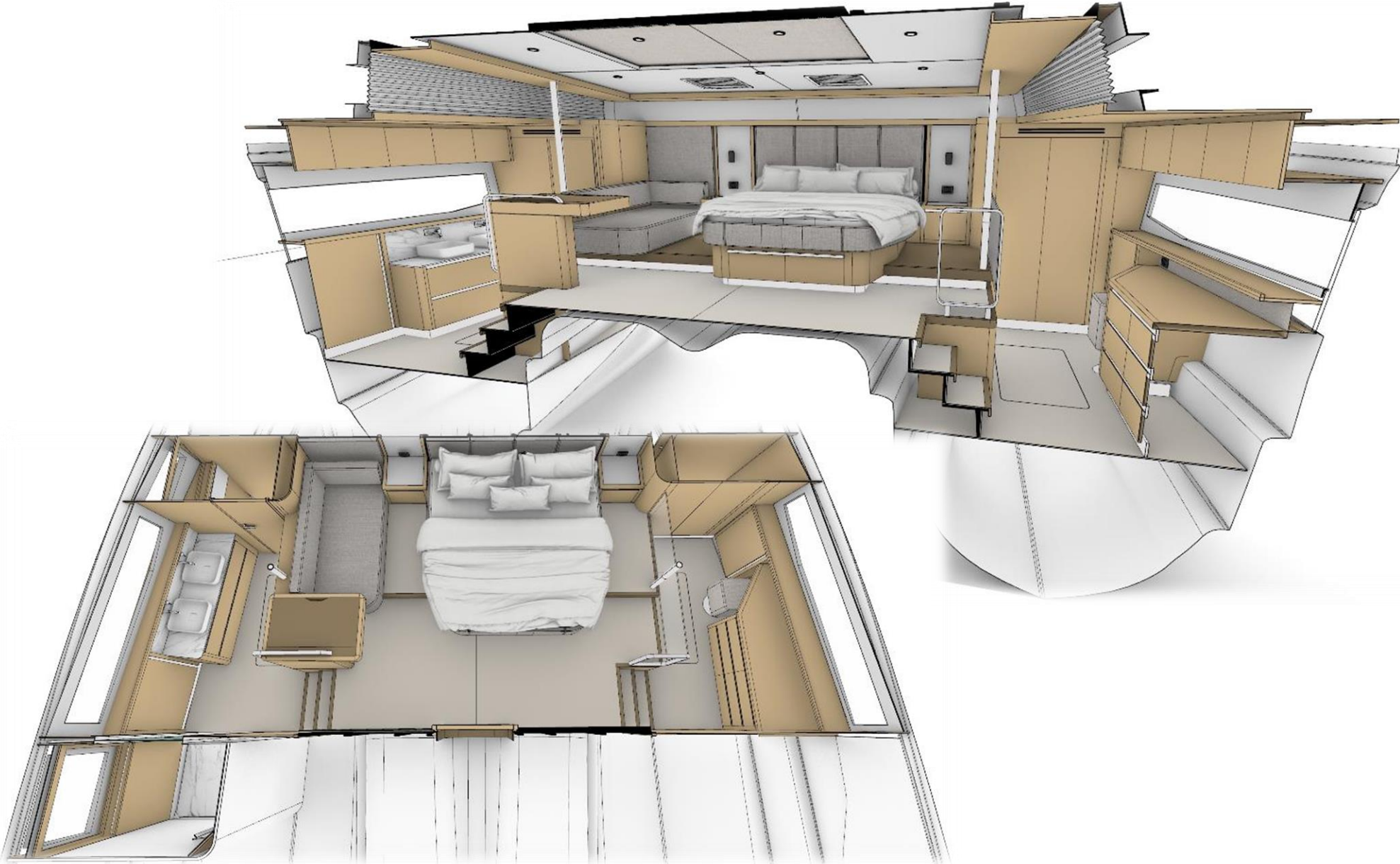

MASTER CABIN



MASTER CABIN



MASTER CABIN



PORT GUEST CABIN

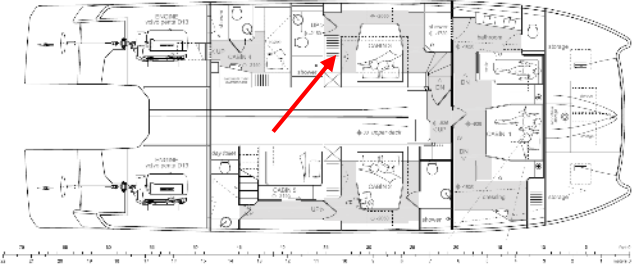

PORT GUEST CABIN



STARBOARD GUEST CABIN



STARBOARD GUEST CABIN

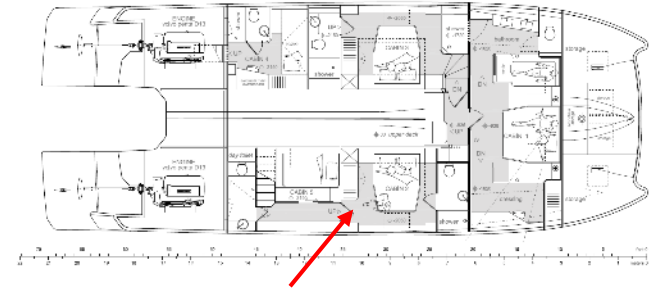

STARBOARD GUEST CABIN

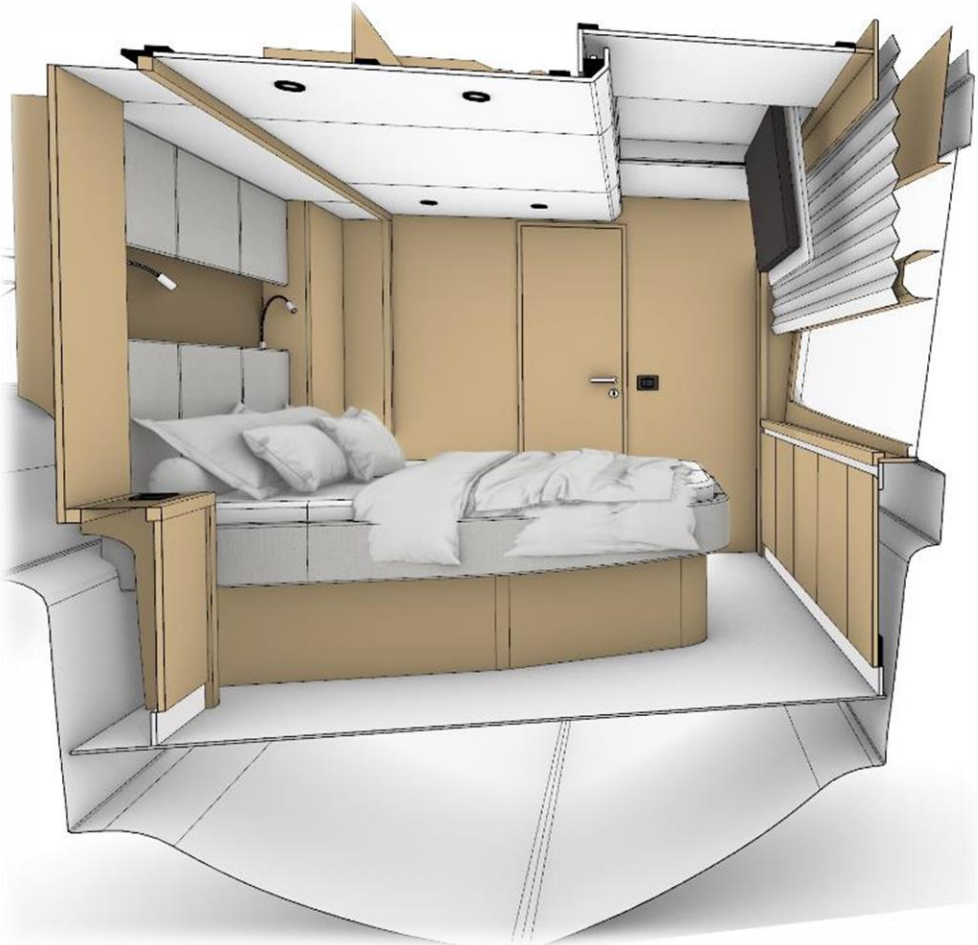

GUEST CABIN



CREW CABIN

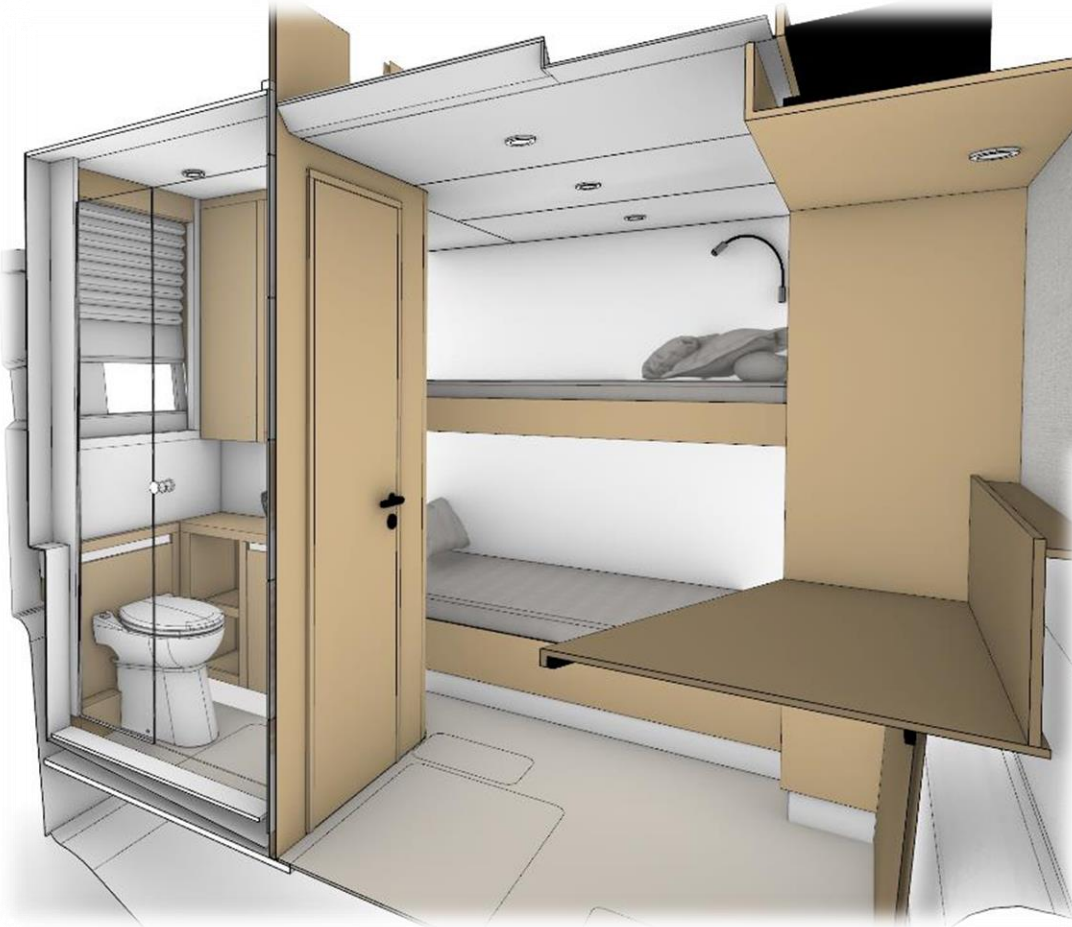

Dinghy launching operation



